

SPECIFICATIONS

Display:	1¼"-high LCD (½" digits)
Accuracy:	Cat. No. 4157 ±1°C (5 to 25°C); otherwise ±1.5°C Cat. No. 4158 ±0.5°C at tested points otherwise ±1.5°C
Resolution:	0.1°F or °C
Temperature Range:	14.2 to 131.0°F (–9.9 to 55.0°C)
Readings:	display updates every 30 seconds
Accessories:	Always-Hold™ suction cup, extra battery, hook and loop tape
Size:	1 x 2½ x ½"
Weight:	½ oz.

BEFORE USING

1. Unit is shipped with battery installed. Unit is ON and displaying current ambient temperature.

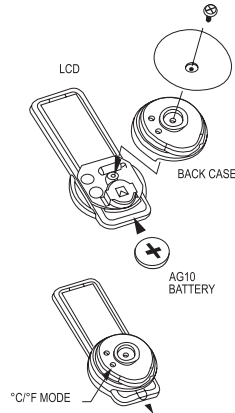

2. If display is not showing temperature, replace battery with extra one supplied. (See Battery Replacement.)

SETTING FAHRENHEIT (°F) OR CELSIUS (°C): MODE

1. Hold unit in one hand with back facing up. Slightly fold back suction cup. MODE opening is visible on lower left side of unit back.
2. With other hand, insert tip of bent paper clip in MODE opening. Press paper clip firmly and hold for one second. Remove paper clip. Reading will change from °F to °C or °C to °F.

Note: SET opening on back of unit has no function on this model.

MOUNTING UNIT

Note: Because refrigerators have varying internal air temperatures, unit should be placed as close as possible to materials being observed.

1. Free-standing – unit may be set on any flat surface.
2. Suction cup – wet suction cup with warm water. Apply to any clean surface.
3. Hook and loop tape – remove paper cover from one piece of Hook and loop tape. Press Hook and loop tape firmly onto suction cup. (Suction cup will flatten.) Remove tape from other Hook and loop tape piece. Press Hook and loop tape firmly onto selected surface for mounting unit. Press unit firmly in place.

Note: Temperatures above 100°F are indicated by “100” at the top of the display.

ULTRA™ THERMOMETER ACCURACY

Ultra™ thermometers are tested at selected test points to be within tighter than normal tolerances to assist in providing improved accuracy. Other points will not

necessarily fall within the same accuracy as those found at the selected test points, but will be within an accuracy of $\pm 1.5^{\circ}\text{C}$.

ALL OPERATIONAL DIFFICULTIES

If this unit does not function properly for any reason, replace battery with fresh 1.5 volt silver-oxide battery. (See Battery Replacement.) Low battery power can occasionally cause any number of “apparent” operational difficulties. Replacing battery with a fresh one solves most difficulties. Equivalent battery replacements are 1.5 volt silver-oxide battery.

Note: If unit is exposed to rapid changes in temperature, moisture may condense on internal electronic parts or on display. (Symptoms include erratic, incorrect, or no readings on display.) To dry out, open unit by following steps 1,2 in Battery Replacement. Allow to dry at room temperature for 24 hours. Close unit by following steps

6,7 in Battery Replacement.

Note: If unit is operating in temperatures below recommended range, liquid crystal display may freeze.

BATTERY REPLACEMENT

1. To open unit, grasp suction cup and turn counter-clockwise until it can be removed or use a screwdriver to remove the screw.
2. Remove BACK CASE.
3. Hold unit in one hand.
4. With other hand, use tip of paper clip to put pressure on top of battery. Press firmly on top of battery until it slides out.
5. With +side facing up, slide fresh battery in place.
6. Replace BACK CASE.
7. Grasp suction cup. Replace screw in opening in center of BACK CASE. Turn suction cup by hand, clockwise or use a screwdriver until it is firmly in place.

WARRANTY, SERVICE, OR RECALIBRATION

For warranty, service, or recalibration, contact:

TRACEABLE® PRODUCTS

12554 Old Galveston Rd. Suite B230

Webster, Texas 77598 USA

Ph. 281 482-1714 • Fax 281 482-9448

E-mail support@traceable.com • www.traceable.com

Traceable® Products are ISO 9001:2015 Quality-Certified by DNV and ISO/IEC 17025:2017 accredited as a Calibration Laboratory by A2LA.

Cat. No. 4157 / 4158

Traceable® is a registered trademark of Cole-Parmer.

Ultra™ is a trademark Cole-Parmer.

©2020 Traceable® Products. 92-4157-00 Rev. 6 092524

TRACEABLE® ECONO DIGITAL REFRIGERATOR THERMOMETER INSTRUCTIONS